

Atwell

self-adhesive Labellers

HM Linerfree® /Linerless Systems

END-OF-LINE SOLUTIONS



- A** Unique CO2 reducing and cost saving
- A** No waste, 100% usage of paper
- A** Up to 60% more paper on the rolls provide 60% more operating time
- A** Up to 30% reduction on total labelling cost
- A** Increased print head life up to 50% longer
- A** Change label length and format without changing the label reel
- A** Reduction of the carbon footprint
- A** Reduction of landfill tax on disposable waste

HM Linerfree®/Linerless systems - labelling without liner/backing paper

HM Linerfree®/Linerless technology provide unique logistical advantages as they eliminate handling costs on the production line and increase efficiencies significantly. Furthermore, increased production efficiencies are achieved as the label rolls contain twice as much paper making it ideal for continuous production lines.

Users of HM Linerfree®/Linerless systems are achieving a number of significant advantages in relation to environment, reduction of operating costs, flexibility and logistics.

H M[®]
SYSTEMS

U
grow it...

...we'll label it

Fast, Reliable and Easy to use
Semi Automatic and Bespoke Fully
Automatic Labelling Systems

U
pick it...

...we'll label it

Fast, Reliable and Easy to use
Semi Automatic and Bespoke Fully
Automatic Labelling Systems

U
sell it...

...we'll label it

Fast, Reliable and Easy to use
Semi Automatic and Bespoke Fully
Automatic Labelling Systems

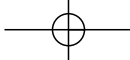

Technical Specification

HM LINERFREE® PRINTER, 203 DPI
 Resolution203 dpi / 8 dots pr. mm
 Print speed51 - 304 mm/sek.
 Feed rate51 - 304 mm/sek.
 Print width104 mm
 Label width25 - 118 mm
 Print length6 - 150/350 mm
 Label length.....50 - 50-150/350 mm

HM LINERFREE® PRINTER, 300 DPI
 Resolution300 dpi/12 dots pr. mm
 Print speed50 - 254 mm/sek.
 Feed rate50 - 254 mm/sek.
 Print width105,7 mm
 Label width25 - 118 mm
 Print length6 - 150/350 mm
 Label length.....50 - 50-150/350 mm

HM LINERFREE® APPLICATORS:
 Dispenser module150 mm/350 mm
 Pneumatic applicator
 - stroke length200 mm
 Hand mounting unit

STRUCTURE
 Print technologyDirect thermal transfer
 Forward stroke motor ..Stepper motor
 Right/left usageBoth
 Run-out alarmLabel-run out alarm

OPERATION

DisplayLCD display with back light
 KeyboardFunction keys
 Language.....GB, D, NL, F, I, DK

INTERNAL CONTROL
 ControlMicroprocessor
 Serial.....4 x RS 232, 1 x RS 422, 1 x RJ 785

MACHINE SPECIFICATIONS

Material.....Anodized aluminium and stainless steel
 IP-fatigue limit.....Dispenser IP 32
 Dimensions (HxWxD)....478 x 355 x 784 mm
 Weight (approx.)15kg, steering box 10-15kg
 Voltage/output.....230 V / 200 W
 CertificationsCE

OPTIONS

Ethernet.....10/100 mb network card
 MCL.....Printer as independent communicating unit
 SoftwareCode soft

HM LINERFREE® PAPER

Standard width (Stock) 49, 70, 98 mm
 Standard colour (Stock) White
 Special colour/LogoPlease contact us for further info

Produced under strict quality control, HM Linerfree® thermal paper is coated on both sides, and the adhesive and silicone are developed to achieve a self-cleansing effect. These facts combined ensure that HM Linerfree® paper offers the highest possible level of print quality and dependability

We reserve the right to make changes
 ALL IPR RESERVED BY HM SYSTEMS

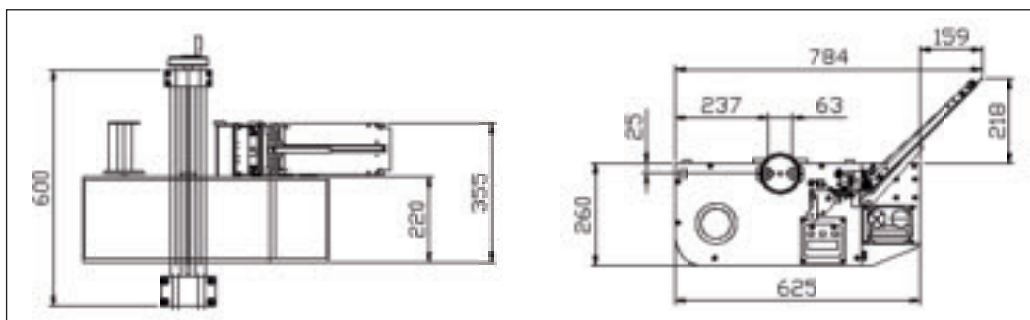

Full range complete labelling systems for Wraparound, Front & Back, Top and Top/Bottom, Print and Apply requirements. Cross Web labellers, Film Labellers, Bespoke specialist applications.

Atwell
 self-adhesive **Labellers**

Unit 18, Bolney Grange Business Park
 Stairbridge Lane, Hickstead
 West Sussex RH17 5PB ENGLAND
 Tel 01444 239970 Fax 01444 246609
 E sales@atwell-labellers.co.uk W www.atwell-labellers.co.uk

As part of our continuing policy of improvement we reserve the right to change this specification without notice.



U pack it...
 ...we'll label it
 Fast, Reliable and Easy to use
 Semi Automatic and Bespoke Fully Automatic Labelling Systems

U fill it...
 ...we'll label it
 Fast, Reliable and Easy to use
 Semi Automatic and Bespoke Fully Automatic Labelling Systems

U make it...
 ...we'll label it
 Fast, Reliable and Easy to use
 Semi Automatic and Bespoke Fully Automatic Labelling Systems